

# 🔍 VOCABULARY search

1 Answer the questions below.

Where do students ...

- 1 ... do experiments? – \_\_\_\_\_
- 2 ... look for and get books? – \_\_\_\_\_
- 3 ... put their bags and other things? – \_\_\_\_\_
- 4 ... study technology? – \_\_\_\_\_
- 5 ... have lunch? – \_\_\_\_\_
- 6 ... get ready for PE lessons? – \_\_\_\_\_
- 7 ... have PE? – \_\_\_\_\_
- 8 ... paint and draw? – \_\_\_\_\_

What other rooms can there be at a school?

2 Read the description of a school interior and fill in the scheme on page 9.

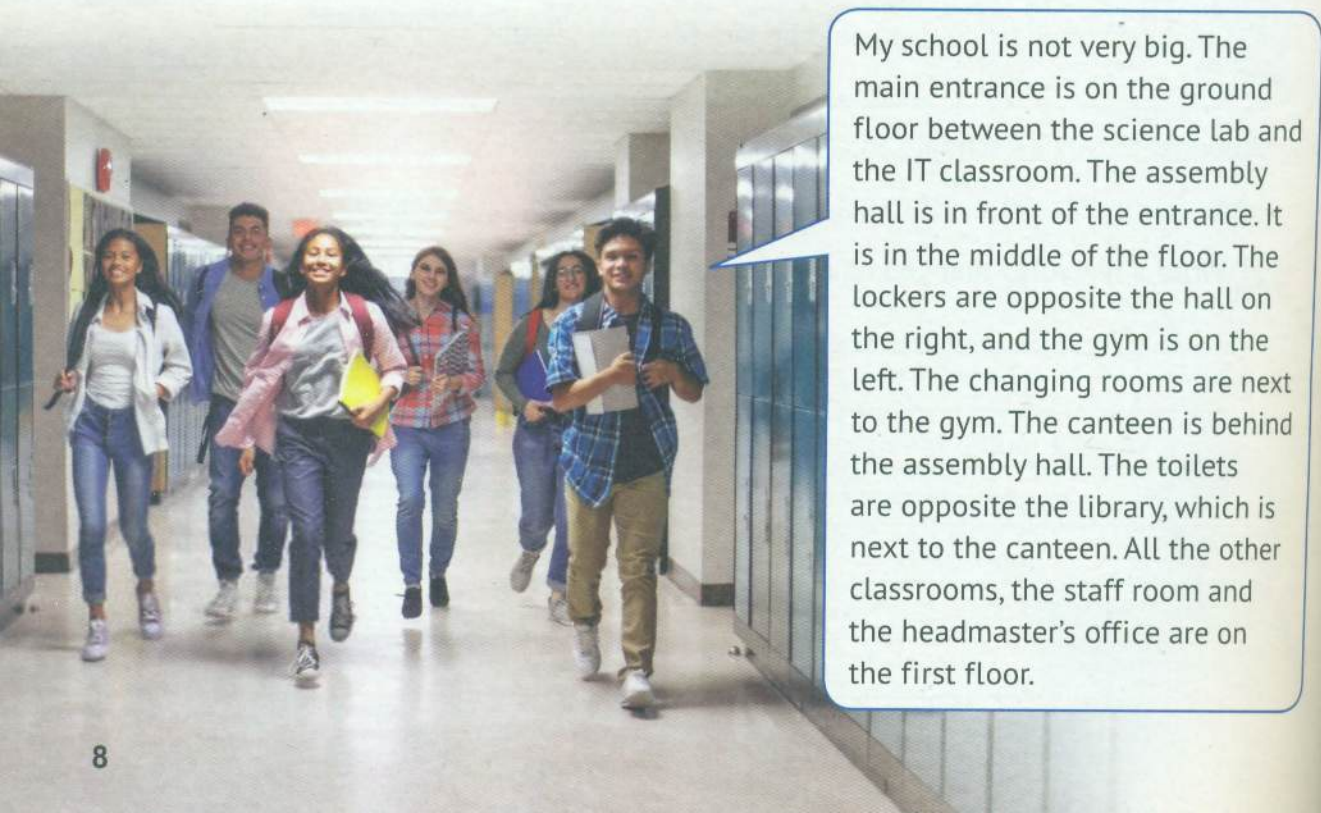

My school is not very big. The main entrance is on the ground floor between the science lab and the IT classroom. The assembly hall is in front of the entrance. It is in the middle of the floor. The lockers are opposite the hall on the right, and the gym is on the left. The changing rooms are next to the gym. The canteen is behind the assembly hall. The toilets are opposite the library, which is next to the canteen. All the other classrooms, the staff room and the headmaster's office are on the first floor.

**Ground floor**

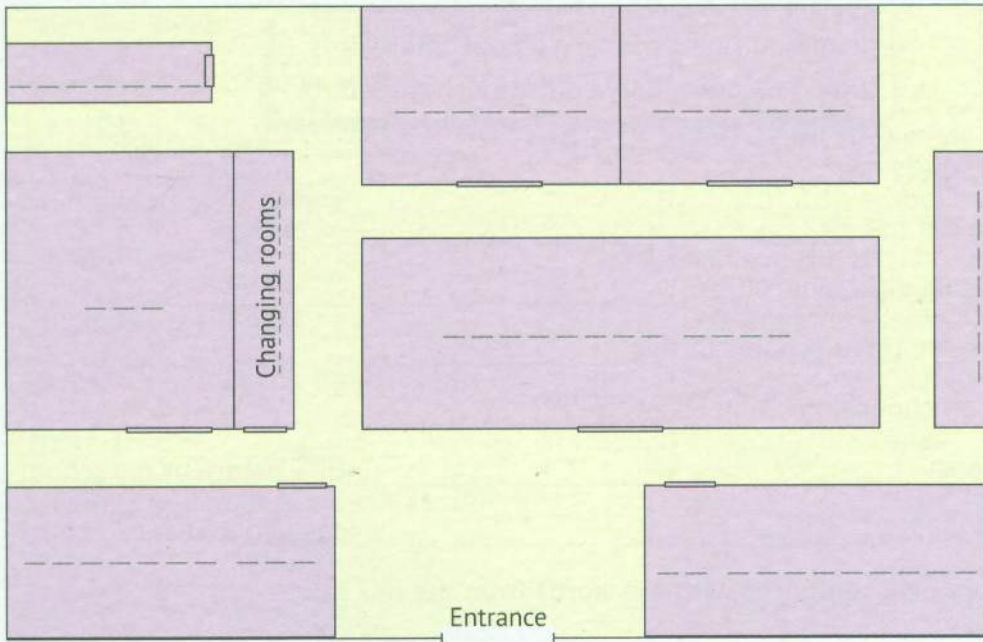

**3 a) Sort out the items below according to a place where they can be found. Some items can be placed in more than one room.**

a microscope, desks, chairs, a sink, a stage, a bookcase, balls, computers, a piano, hangers, a board, a guitar, clothes and shoes, a baseball bat

Science lab	
IT classroom	
Music classroom	
Gym	
Changing rooms	
Assembly hall	
Library	
Toilets	

**b) Add any other things that can be found in these rooms.**